

centaur

from SKOPE

VERTICAL CHILLERS & FREEZERS



BC074

Model	Weight (kg)	Integral/Remote	Chiller/Freezer
BC074-1ROOS-E	110	Integral	Chiller
BC074-1FOOS-E	110	Integral	Freezer

	External (mm)	Internal (mm)		
Height*	1930	1450	Gross Volume	557 litres
Width	740	610	Total Shelf Area	1.17m ² (excluding floor)
Depth	803	630	Floor Area	0.59m ²

- 3 adjustable shelves per door as standard
- Minimum 200mm clear ventilation space required above cabinet top

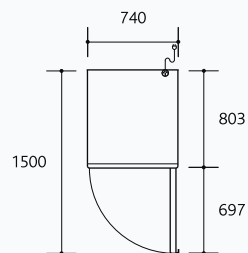

Integral top view

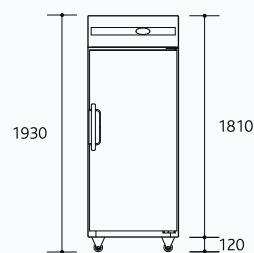

Integral front elevation

BC074
1 DOOR



BC126

Model	Weight (kg)	Integral/Remote	Chiller/Freezer
BC126-2RROS-E	203	Integral	Chiller
BC126-2FFOS-E	203	Integral	Freezer

	External (mm)	Internal (mm)		
Height*	1930	1450	Gross Volume	1032 litres
Width	1260	1130	Total Shelf Area	2.16m ² (excluding floor)
Depth	803	630	Floor Area	1.02m ²

- 3 adjustable shelves per door as standard
- Minimum 200mm clear ventilation space required above cabinet top

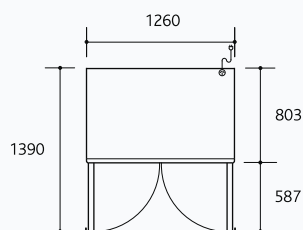

Integral top view

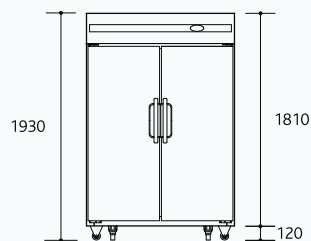

Integral front elevation

BC126
2 DOOR

Use the following table to interpret the model names for Centaur Vertical Chillers and Freezers i.e BC074-1ROOS-E

B	C	074	1	ROO	S	E
1	2	3	4	5	6	7

1. Brand 2. Centaur
4. Door Quantity
6. S: Stainless Steel

3. Cabinet Length 740/1260/1500/1900mm
5. R: Refrigerator/F: Freezer
7. E: Forced Circulation Type

CODES